

TIM-HL
3/92

TIMMERMAN HALL
BASEMENT

REVISED 1/12

NOTE: WHEN REPORTING INSTRUCTIONAL SPACE (CASA), DOCUMENT NOS. AS INDICATED

NOTE: SPACES 133, 133A, 133B & 133C ARE ASSIGNED TO DAY CARE CENTER.
 SEE MRT-HL DWG. 22.2 FOR CONNECTION BETWEEN BLDGS. E

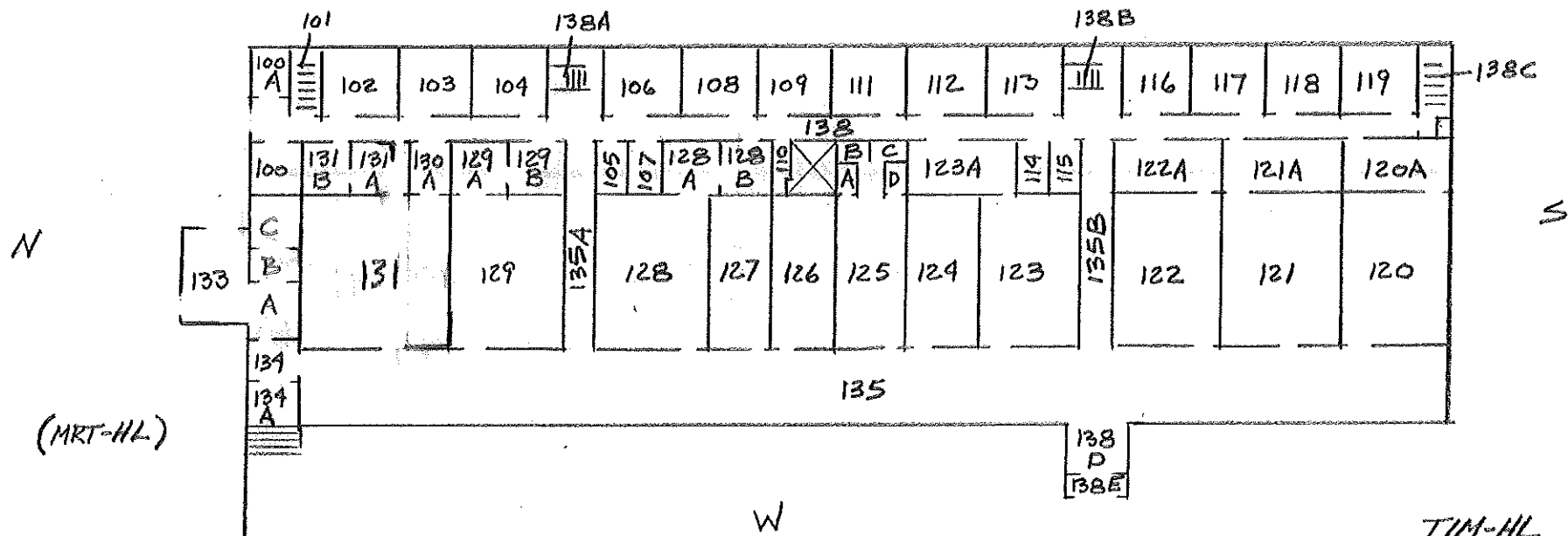

TIM-HL
 4/96
TIMERMAN HALL
 FIRST FLOOR

NOTE: WHEN REPORTING INSTRUCTIONAL SPACE (CASA), PRECEDE NO. WITH NUMERICAL ZERO (0)

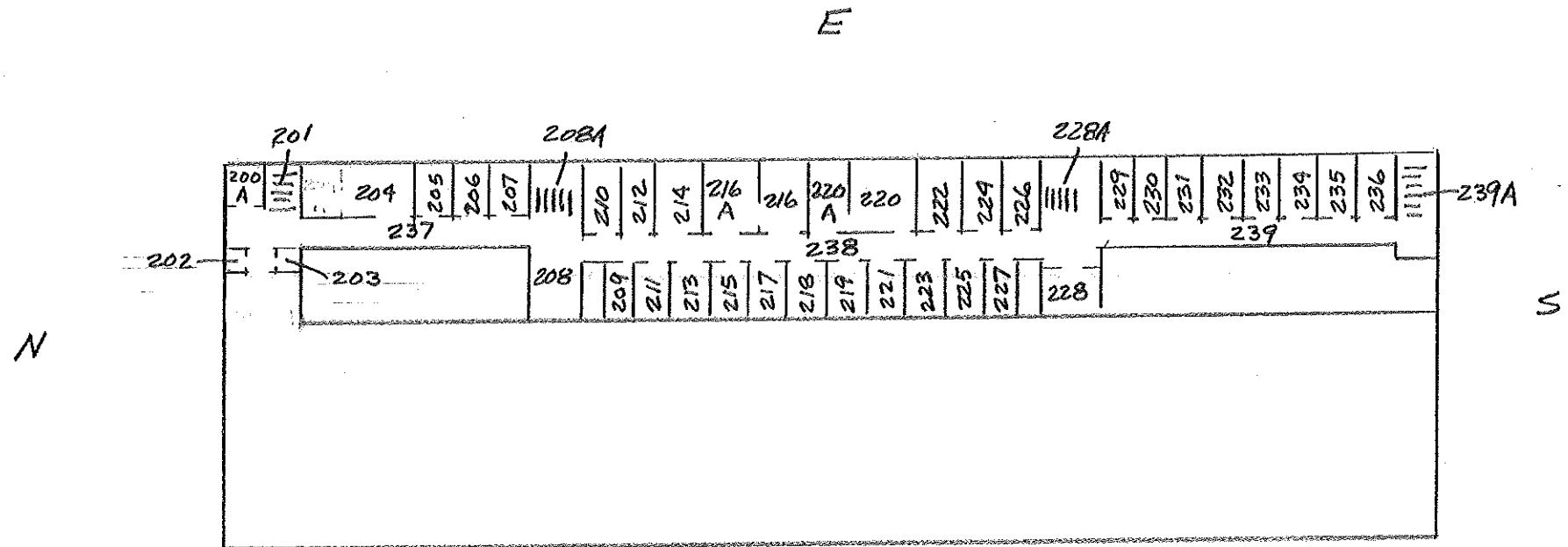

TIM-HL
3/92

TIMMERMAN HALL

MEZZANINE FLOOR

NOTE: WHEN REPORTING INSTRUCTIONAL SPACE (CASA), PRECEDE NO. WITH NUMERICAL ZERO (0)

REVISED 12/14

33.3