

REVISED 09/05

N

E

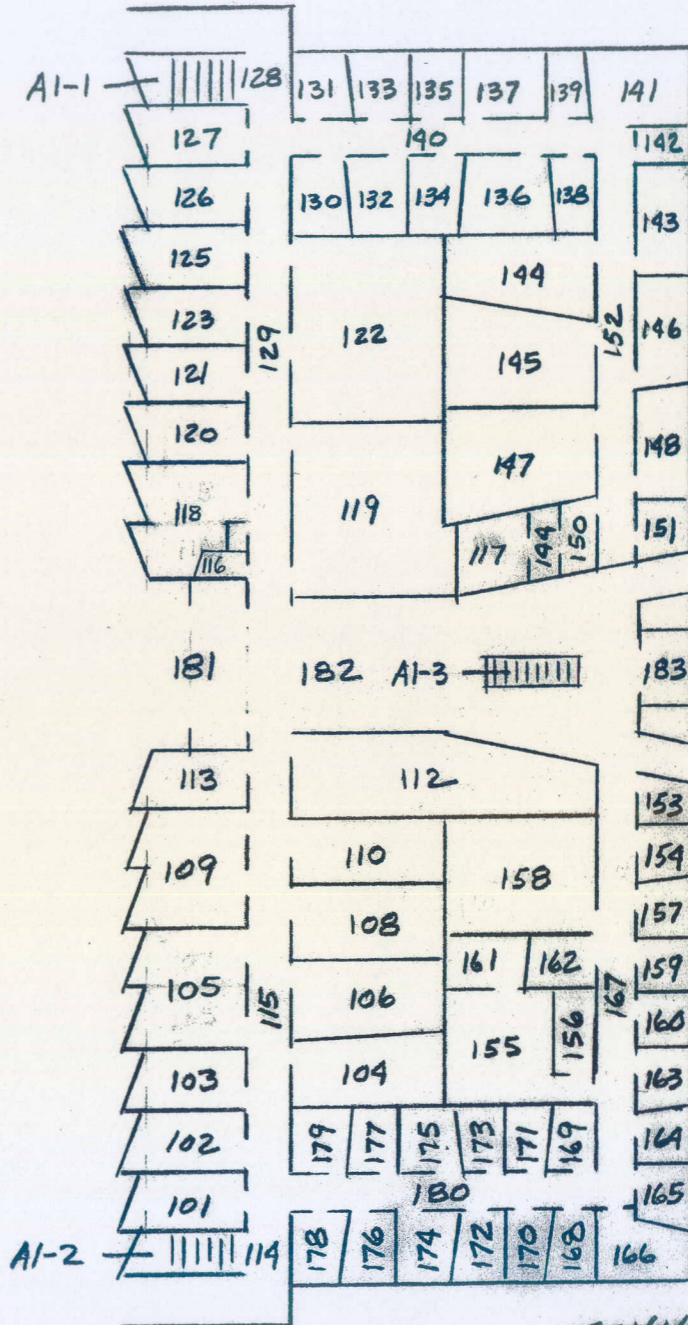

(CRN-MC)

S

NOTE: WHEN REPORTING INSTRUCTIONAL SPACE (GASA), PRECEDE NO. WITH ALPHA A

SCH-HL  
1/96

SCHUETTE HALL  
LOWER LEVEL

NOTE: WHEN REPORTING INSTRUCTIONAL SPACE (CASA), PRECEDE NO. WITH ALPHA A

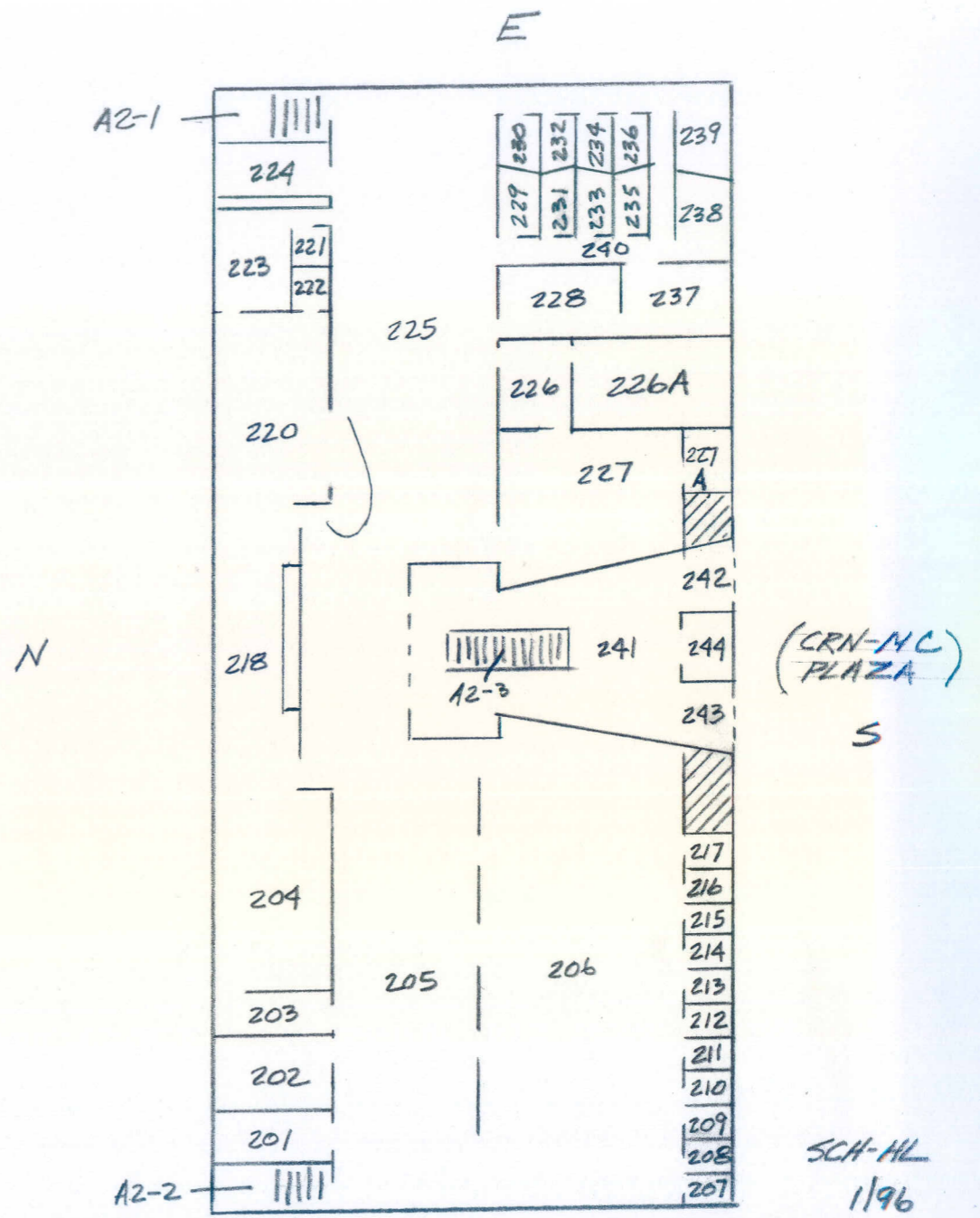

REVISED 10/09

SCHIETTE HALL  
PLAZA LEVEL

REVISED 5/07

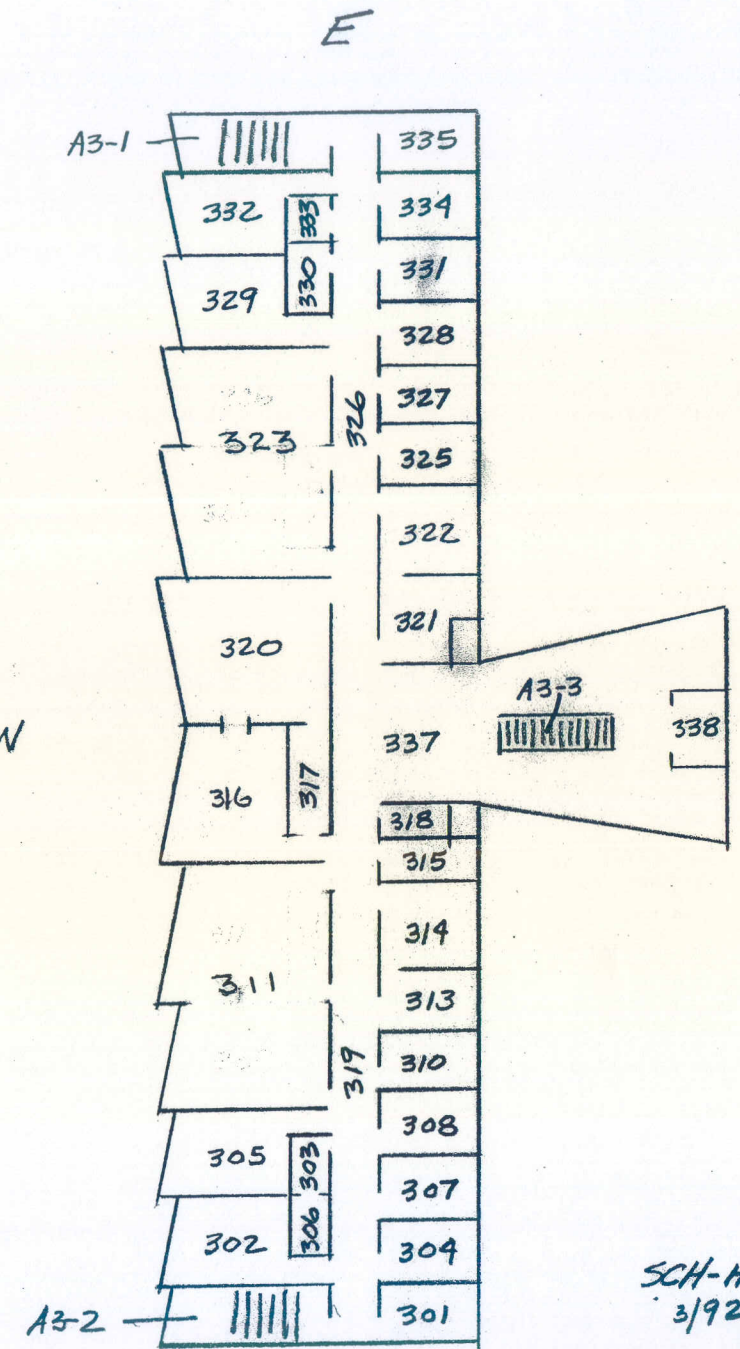

NOTE: WHEN REPORTING INSTRUCTIONAL SPACE (CASA), PRECEDE NO. WITH ALPHA A

SCH-HL  
3/92

SCHUETTE HALL  
UPPER LEVEL